

teknion expansion meeting tables

teknion

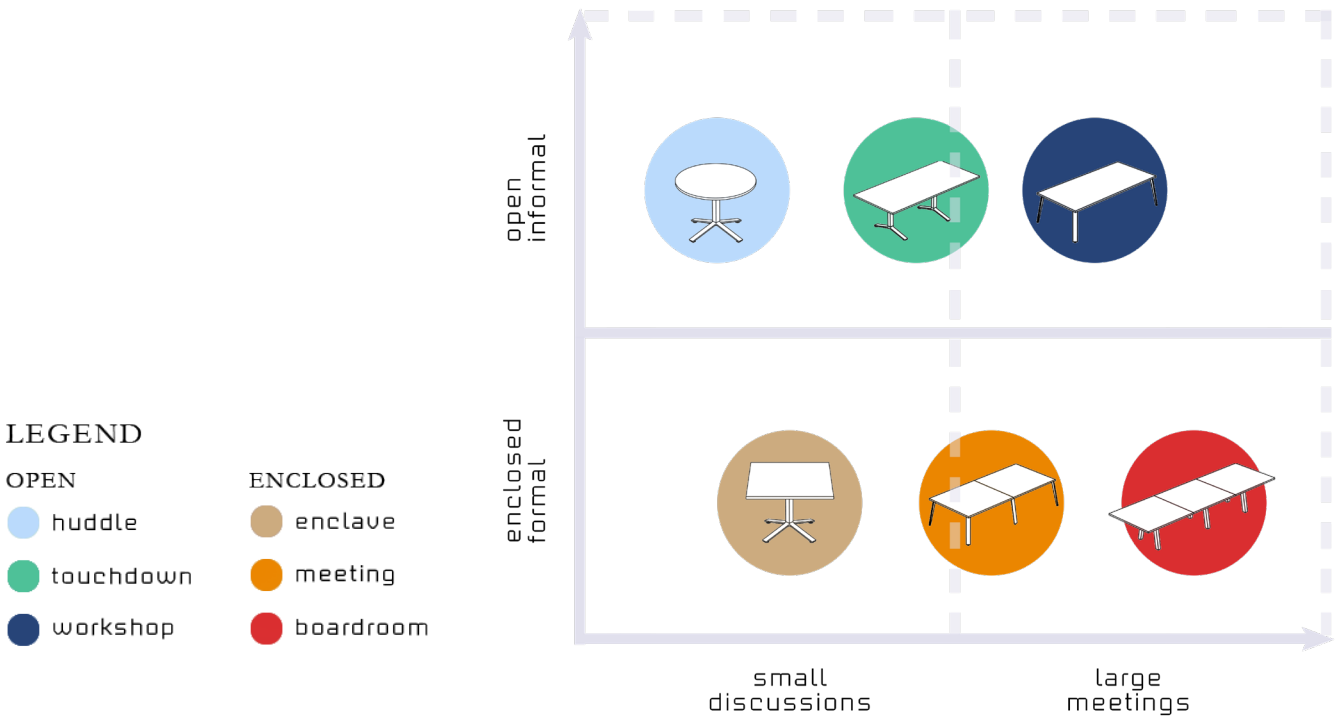

02

Collaboration is central to every organisation. As companies move towards collaborative work structures, adapting to all types meeting environments is key. Expansion meeting table series offers small huddle spaces to large workshop configurations, from private enclaves to boardrooms.

To optimise your company space for various types of collaboration, thrive in this hybrid work environment with our expansion meeting tables.

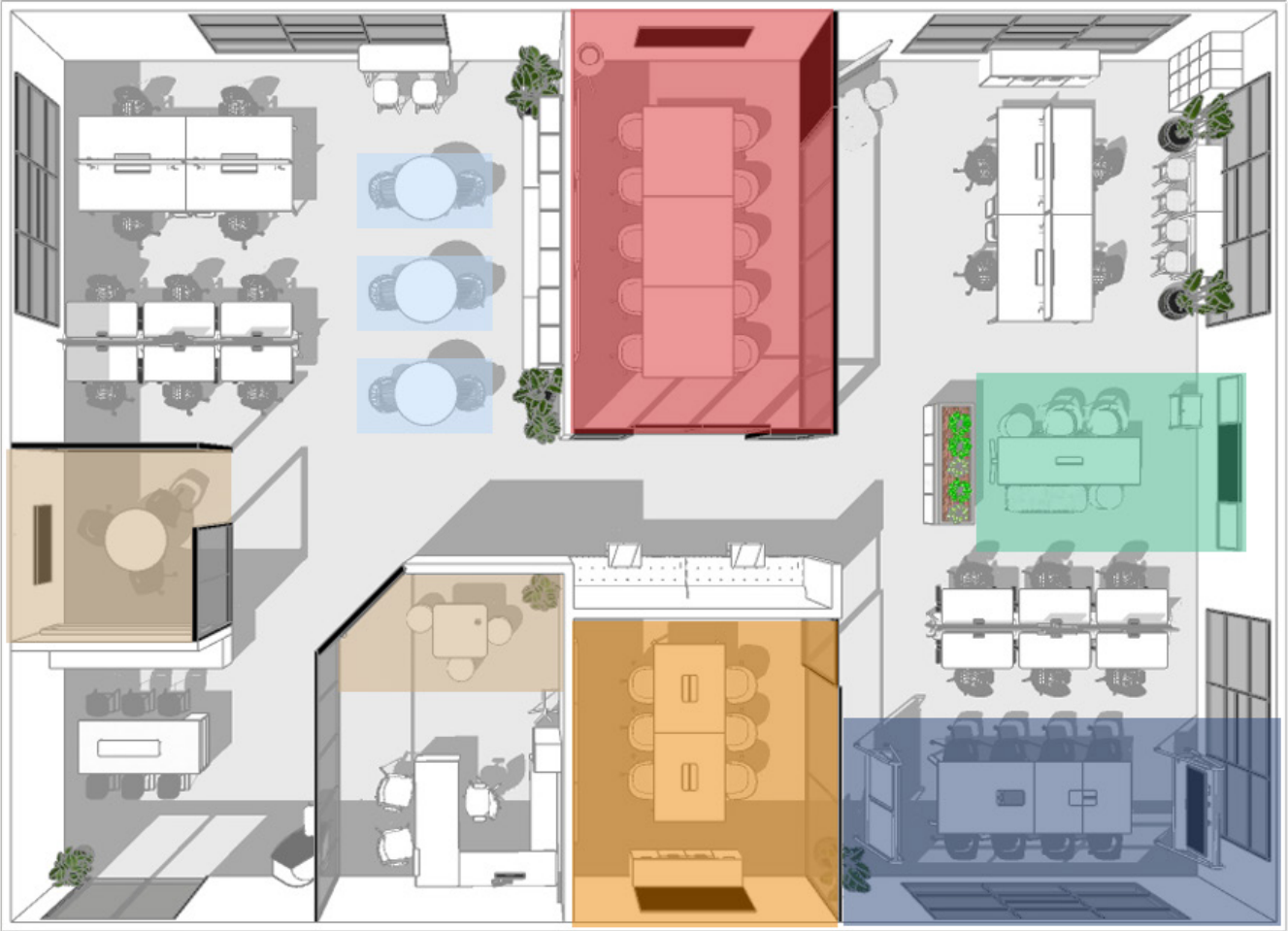



worksurfaces
*Source Laminate,
Campus Oak*

frame
*Foundation,
Greystone*

seating
*Just-Us:
Khaki Mesh;
Substance, Chert*

huddle
An open space where employees can have a quick casual discussion to align their productivity or for a quick update. This small round expansion table is meant for short discussions and tactical issues.



worksurfaces
Source Laminate,
Vintage Oak

frame
Mica,
Platinum

seating
Collaborative Ottoman:
Homage, Guild

private office
Placed in a quieter area, this expansion table with club chairs is paired with a private workstation cabin for a more personal discussion which is effective for confidential matters and communication.



worksurfaces
Source Laminate,
Graphite

frame
Mica,
Very White

seating
Zones Bench:
Greystone Beech
Arch Angle, Selene

Zones Chairs:
Zones Seating Plastic,
Crisp Grey
Greystone Beech
Arch Angle, Selene

Collaborative Ottoman:
Haptic, Superbloom

touchdown
A perfect space for intensive yet casual brainstorming session. This open collaborative space with eclectic mix of zones bench and ottoman offers a playful setting which encourages spontaneous participation, generating and discussion of ideas openly.



worksurfaces
Source Laminate,
Campus Oak

frame
Mica,
Platinum
Accent,
Blue Sage

seating
Zones Club Chair:
Cross Grain,
Spring wood

meeting
A hybrid space where it can room more attendees for a semi-formal interaction. The expansion table with an injection of accent colour and fabric seating, placed in an enclosed glass island serves adequate privacy in a high energy space like a think tank. This adaptive space empowers productivity in a less structured and free-flowing discussion.



worksurfaces
*Foundation Laminate,
Pure White*

frame
*Mica,
Very White,
Accent,
Atmosphere*

seating
*Wilkhahn Occo Chair:
1: Ebony,
Filar, Gauge
2: Latte
Actuate, Suffuse*

*3: Grey
Bitstream, Grey Code
4: Atrium White
Bitsream, White Noise*

workshop
Thoughtful and comfortable setup to minimise social barriers to encourage effective engagement and participation. The cosy Occo chairs enable involvement for the purpose of meetings, conferences, trainings, workshops and more. A perfect hub for interaction, employees are more likely to engage in conversations and generate new, inspiring ideas.



worksurfaces
Source Laminate,
Vintage Oak

frame
Foundation,
Ebony

seating
Zones Club Chair;
Fine Grain, Garnet Sand

boardroom
This formal space is suited with an expansion table and leather seating for a high-level business meeting. It is an ideal environment to discuss company-wide policies, setting business goals, reviewing strategic plans and discussing the trajectory of the company.

features

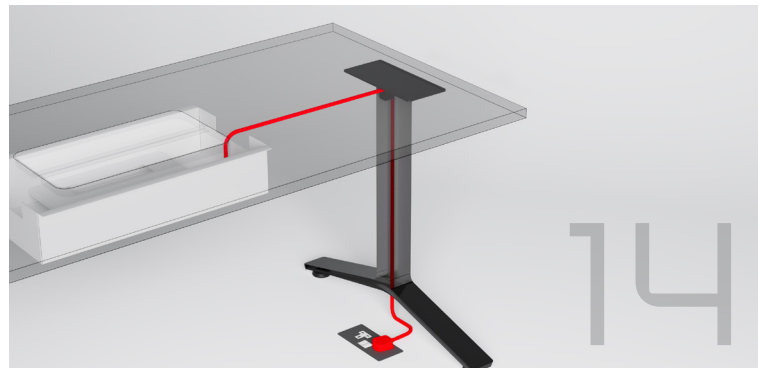
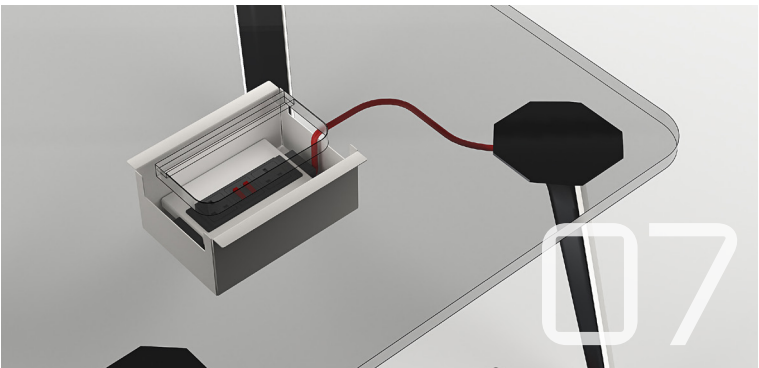
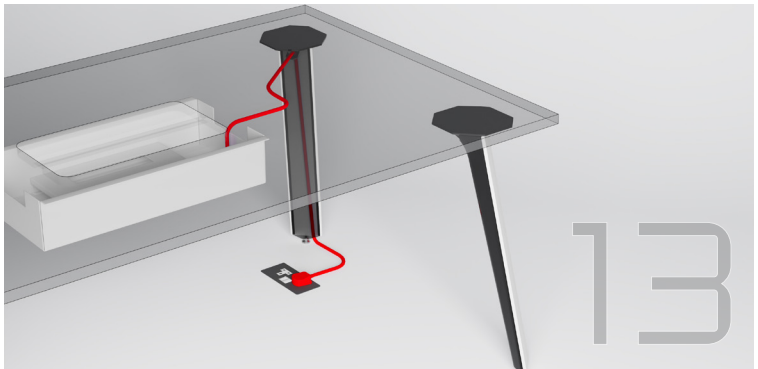
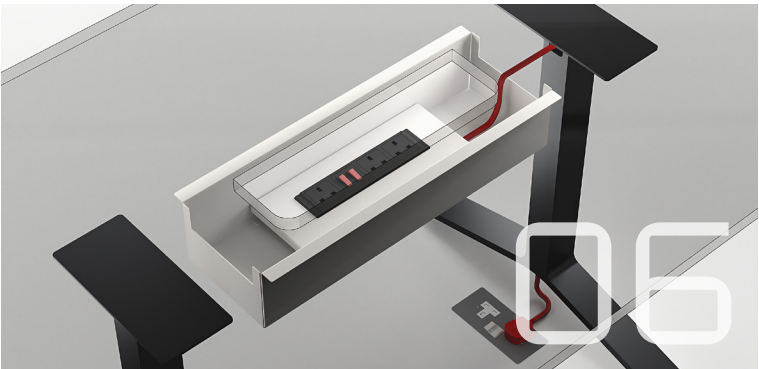
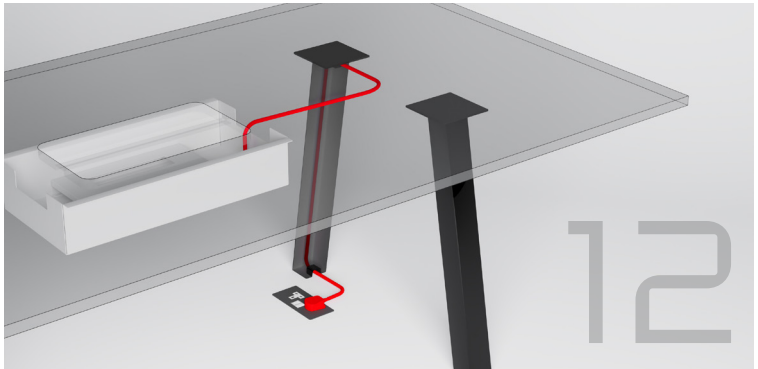
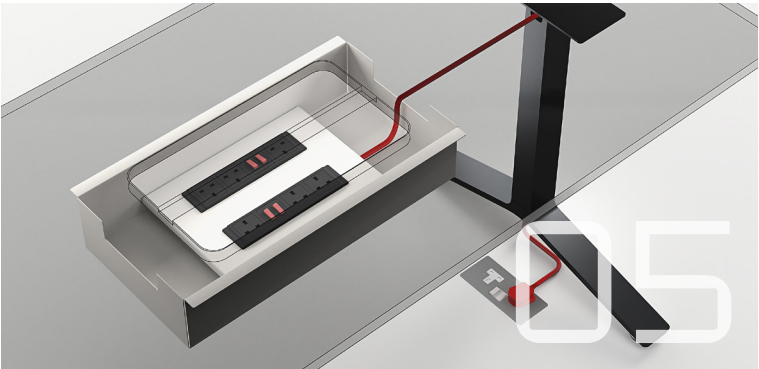

worksurface

cable tray

table leg

integrated cable management

- 01 round corner edge
- 02 straight corner edge
- 03 single-sided laminate flip up
- 04 double-sided laminate flip up

- 05 standard cable tray with double-sided flip up
- 06 standard cable tray with single-sided flip up
- 07 small cable tray with single-sided flip up

- 08 workshop leg
- 09 blade leg*
- 10 blade t-leg
- 11 blade star base
- *Optional 2-tone finishes available.

- 12 workshop leg
- 13 blade leg
- 14 blade t-leg
- 15 blade star base

finishes



laminate – hpl/ lpl

- 01 pure white
- 02 light grey
- 03 oyster grey
- 04 graphite

- 05 bamboo
- 06 campus oak
- 07 vintage oak
- 08 lincoln walnut

paint

- foundation/mica
- 09 very white
- 10 soft gris
- 11 anthracite
- 12 ebony

- accent
- 13 radioactive
- 14 butternut
- 15 hunter
- 16 ink blue

* The finishes are for illustration purposes only, not the actual available finish.

workshop meeting table

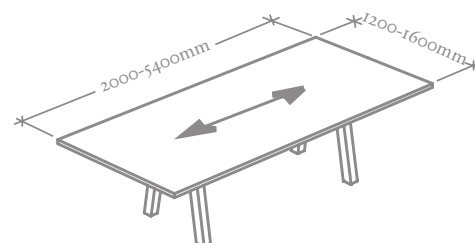

rectangular meeting table-
blade legs

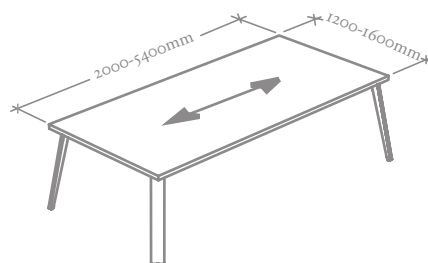

rectangular meeting table-
blade t-legs

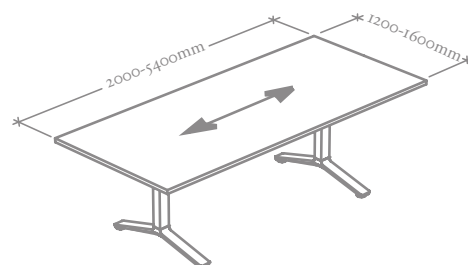

square meeting table-
blade star base

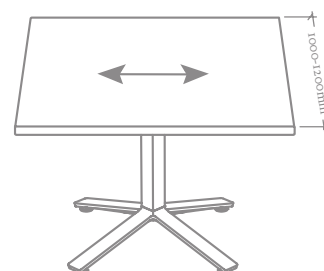

round meeting table-
blade star base

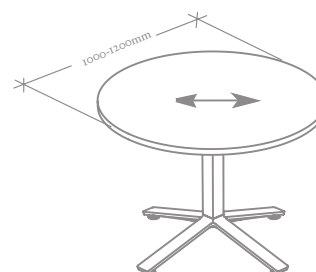

www.teknion.com

IN ASIA

Lot 761 Jalan Haji Sirat
Klang, Selangor
41200 Malaysia
Tel 603.3342.4345
603.3342.3466

IN CANADA

1150 Flint Road
Toronto, Ontario
M3J 2J5 Canada
Tel 866.teknion
866.835.6466

IN THE USA

350 Fellowship Road
Mt Laurel, New Jersey
08054 USA
Tel 877.teknion
877.835.6466

OTHER OFFICES LOCATED IN

Europe, South and Central America,
Middle East and Russia
For regional contact information
go to www.teknion.com

MY 06-22

© Teknion 2022

®, ™ trade marks of Teknion Corporation
and/or its subsidiaries or licensed to it.

Patents may be pending.